

## The online survey that does more...

Research social networks quickly and easily with our new online survey system. It's ideal, for example, for analyzing social integration and social capital, and for conflict management.

Collect not only the attributes of your interview partners online but also their direct relations to other people (called "Alteri"). You can determine additional questions for the Alteri collected via the survey. The relations between your interview partner and these people (the "Ego-Alter relations") are just as easily collected as the relations between the people named (the "Alter-Alter relations").

This network can subsequently be visualized automatically in the online survey system for your interview partner.

## Egocentric network research

You can define your questions for your interview partner (the "Ego") just as you could with a classic survey.

You can choose from a variety of standard question elements available to you.

Here a selection of designs:

The image displays ten different question and answer format designs for an online survey, arranged in a grid. Each design includes a question field, an information icon, and various answer options:

- Design 1 (Top Left):** Radio button selection for Answer 1, Answer 2, Answer 3, and an ellipsis.
- Design 2 (Top Right):** Checkboxes for Answer 1, Answer 2, Answer 3, and an ellipsis.
- Design 3 (Middle):** Radio button selection for Answer 1, Answer 2 (selected), Answer 3, and an ellipsis.
- Design 4 (Below Middle):** Checkboxes for Answer 1, Answer 2, Answer 3, and an ellipsis.
- Design 5 (Bottom Left):** Radio button selection for Answer 1, Answer 2 (selected), Answer 3, and an empty text input field.
- Design 6 (Bottom Left, below 5):** A dropdown menu with "Please select..." and options Answer 1, Answer 2, and Answer 3.
- Design 7 (Bottom Right):** A single empty text input field.
- Design 8 (Bottom Right, below 7):** A single empty text input field.

You can also set questions for other people in addition to those for the Ego.

Through a **name generator** you can easily collect a nearly unlimited number of Alteri.

From time to time, most people discuss important personal matters with other people. Taking the last six months into consideration, who have you talked to about important personal matters? Please enter the names individually in the entry line. You can use first names, nicknames or abbreviations. For this example, you should enter at least one person and no more than eight people.

Please enter the name:

Relevant persons:

John  
 Peter

No matter how many Alteri your interview partner names, you can dynamically ask questions about further attributes of these Alteri.

**Who works at which department?**

Please select...

Where did **Anna** work?

Where did **Peter** work?

Where did **Joe** work?

Please select...  
Marketing  
Research  
Distribution  
Other

Collect additional relations between the Alteri.

You can have as many answer categories as you wish.

Here is an example:

**When you were not present: Have the two people ever done something together?**

<b>Peter</b>	<input type="text" value="yes"/>	<b>John</b>
<b>Peter</b>	<input type="text" value="no"/>	<b>Anna</b>
<b>John</b>	<input type="text" value="don't know"/>	<b>Anna</b>

The egocentric network you are researching can be automatically visualized for your interview partner during the data collection process.

Here is an example:

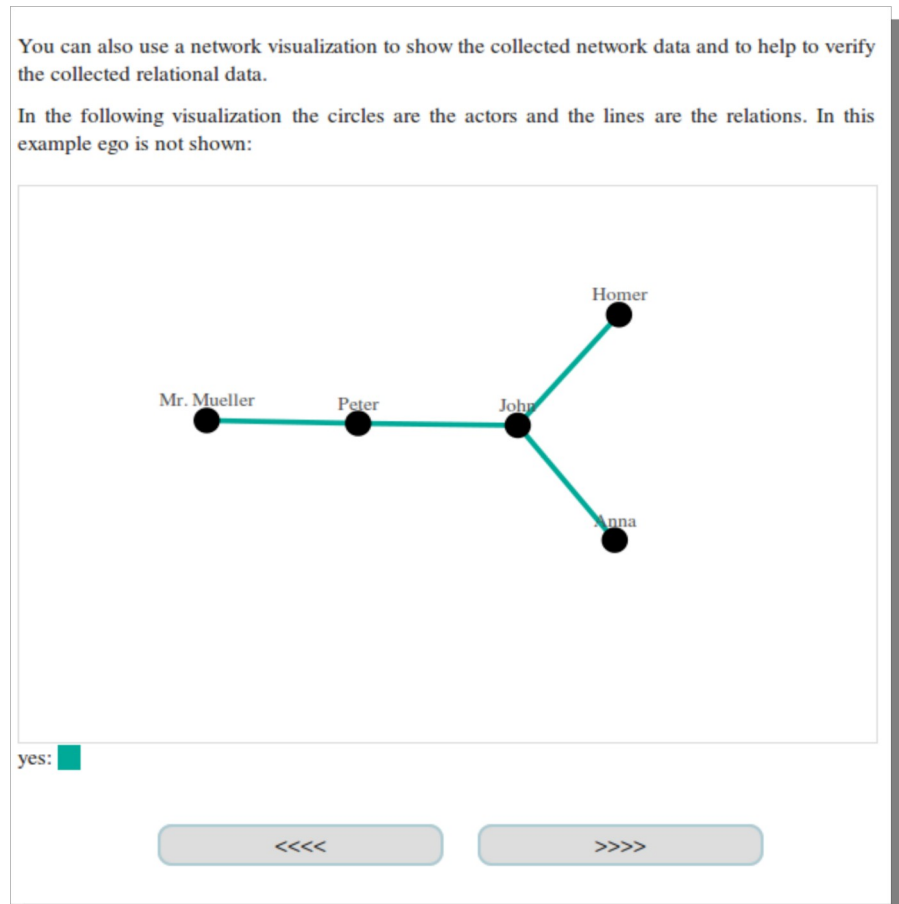

## **Filters**

As with a classic online survey, you can set filter conditions.

Additionally, you can set the filter conditions on the network level. A filter condition on the network level could, for example, be: "Show question X only then, when at least 4 Alteri have been named."

## **Standard interfaces**

Export your survey results anytime as a .csv document or a .net document.

## **Keep an overview**

Retrieve initial statistical information and access figures during the survey.#

## **We do the work**

We configure your desired online survey; it's fast and uncomplicated.#

## **SECURITY takes first place**

Every online survey takes place via an encrypted connection. Your data and that of your interviewees are safe with us.

## The “Simple & Good” Package

Use your valuable time for more important things and leave the work to us. We program your survey for you and make the technical infrastructure for the online survey available to you.

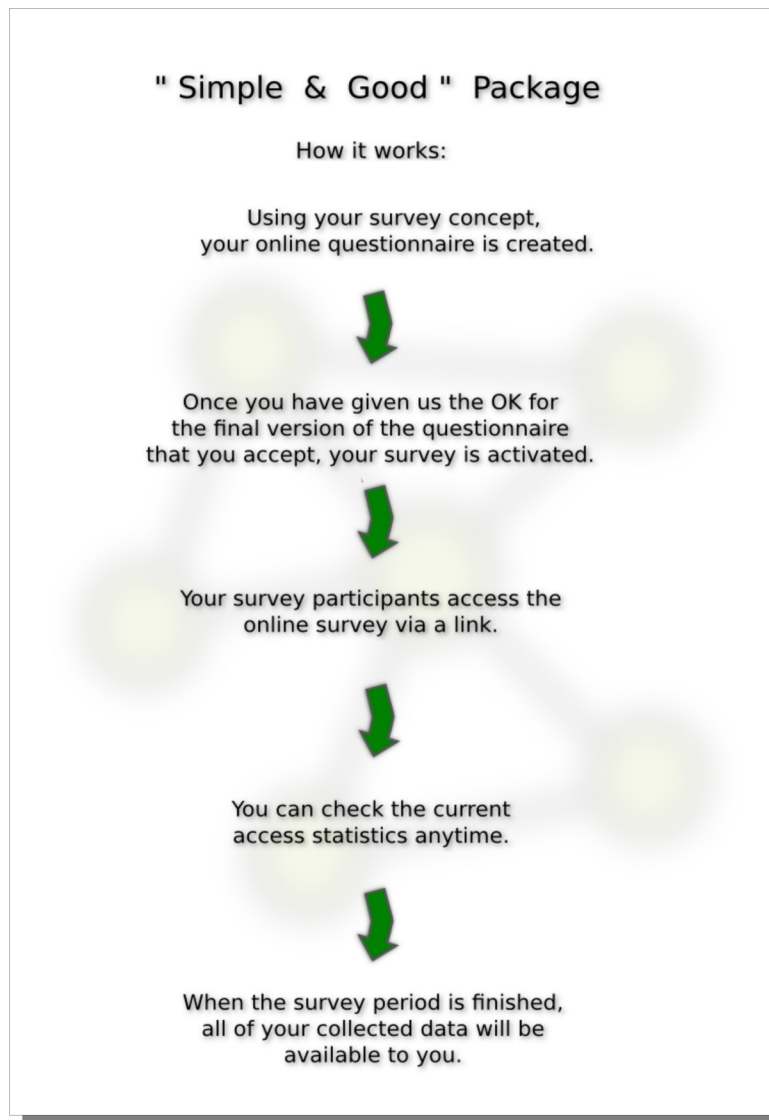

### “Simple & Good” Package

- Up to a 30 day survey length
- Max. 20 standard survey elements
- Up to 1,000 interviewees
- Export formats: csv, net, graphml
- ssl encryption included
- Hosted in Germany

**€320.00** (incl. 19% VAT)

### Individual upgrades and customization

- Each additional standard survey element costs €4.95 (incl. 19% VAT).
- Extend the survey period: every additional ten days is €17.99 (incl. 19% VAT)
- Programming of individual survey elements: prices upon request

**We are happy to respond to your requests at no obligation to you:**

[contact@kronenwett-adolphs.com](mailto:contact@kronenwett-adolphs.com)

Or call us:

**+49 (0) 176 62892 495**

(Opening hours: Mo - Fr 10 AM - 6 PM)

Kronenwett & Adolphs UG (haftungsbeschränkt)  
Pfitznerstr. 15  
69245 Bammental  
Germany

Try our demo survey:

[Demo](#)